

MAVERICK Series

Our Through-Bore Slip Rings



SCHLEIFRING



MAVERICK – Through-Bore Slip Rings

What is a through-bore slip ring?

A through-bore slip ring is a **passive transmission unit*** that is integrated into a system in order to enable the exchange of power, signals and data between the rotating part and the stationary part of the system. The slip ring's **free internal diameter** enables the routing of cables or hoses. The slip ring can be mounted directly on the shaft. (*solely a means of transmission without its own drive system)

The MAVERICK series: maintenance-free and reliable

Our MAVERICK through-bore slip rings offer a superior solution for rotary transmission challenges and excel due to the following characteristics:

- **Maintenance-free:** no servicing required even when used continuously over long periods.
- **Long service life:** developed for long-term and stable usage.
- **Compact design:** optimum use even in confined spaces.
- **Good value for money:** top price/performance ratio through optimized transmission technology.
- **Impressive performance:** high efficiency during the transmission of signals and power.
- **Reliability:** innovative tuft brush technology enables interference-free analog and digital transmission.
- **Safety:** the rubber coating provides for a higher protection class.



Wide-ranging applications

The MAVERICK through-bore slip rings can be used in almost any application. Their flexible design makes them the ideal choice for a wide variety of applications, including:

- **Rotary tables:** perfect integration into high-precision equipment for exact control and transmission of positioning data.
- **Robot arms:** to ensure continuous power and signal transmission for automated systems.
- **Revolving doors:** unobtrusive and efficient solution for the connection of safety systems.
- **Machine tools:** reliable power and signal transmission for precise machining and control.

| Technical features | |
|------------------------|----------------------------------------|
| Free internal diameter | 12.7 mm 25.4 mm 38.1 mm 50 mm |
| Paths | 6, 12, 18, 24 |
| Current | 5 A, 10 A, 15 A |
| Rated voltage | 250 V 250 / 400 V |
| Max. rotational speed | 300 rpm |
| Operating temperature | -20 °C to +60 °C |
| Humidity | 10% to 60% |
| Torque | < 2 Nm |
| Length of rotor cable | 250 mm (without connector) |
| Length of stator cable | 250 mm (without connector) |

PE freely selectable via one of the slip ring's available paths

Installation procedure

The example photo shows a MAVERICK installed on a rotating shaft. Four grub screws connect the rotor to the shaft, which is pushed through the free internal diameter. On the stator there are several installation options in order to integrate the bracket supplied with the slip ring into a holding device provided by the customer.

Rotating inner section (rotor):

The connection to the shaft is by means of four grub screws. This enables the rotating inner section of the MAVERICK to be driven by the shaft.

Outer housing (stator):

The bracket supplied with the slip ring prevents the outer housing of the MAVERICK from rotating. For this purpose, the customer must install a holding device. The bracket can be positioned to suit the customer's needs: The MAVERICK has two mounting options on each side.

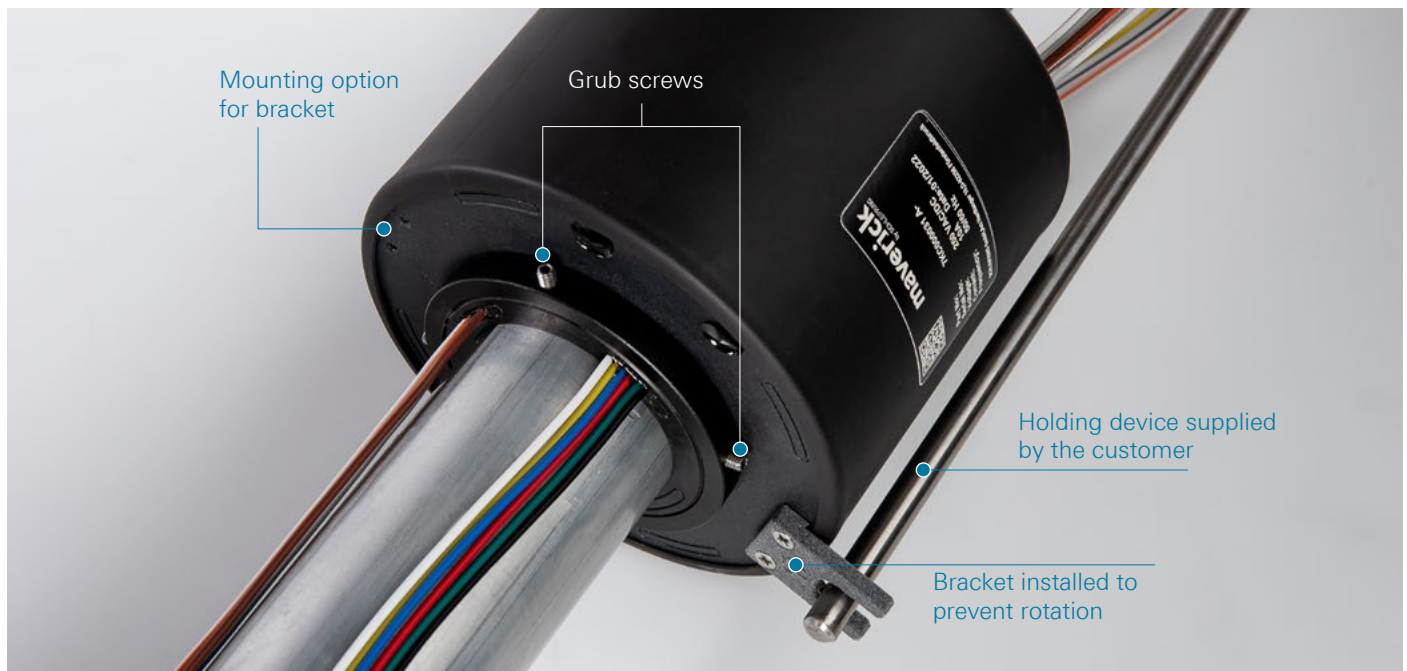

Additional benefits

- **Simple installation:** rapid and straightforward mounting on a rotor shaft.
- **Protection against damage:** a rubber coating protects the MAVERICK against external damage, which is particularly advantageous in confined spaces.
- **Immediate availability:** no long delivery times – the MAVERICK series is available immediately.
- **EU conformity:** meets all European quality and safety standards.
- **Certifications:** complies with RoHS and REACH for environmental friendly and safe use.

MAVERICK – Product overview

| A/B/C [mm] = bracket | ID [mm] = free internal diameter | OD [mm] = outside diameter | N = number of paths | I [A] = current per path | V [V] = rated voltage | | Ltotal [mm] = overall length | Lstator [mm] = stator length | W [g] = weight | Material number |
|-------------------------|----------------------------------------|----------------------------------|---------------------------|--------------------------------|-----------------------------|-----|------------------------------------|------------------------------------|-------------------|--------------------|
| | | | | | ≈ | ~ | | | | |
| 6/ 37/ 32 | 12.7 | 58 | 6 | 5 | 250 | | 46 | 40 | 250 | 7KC000037 |
| | | | | 10 | 250 | 400 | 55 | 49 | 230 | 7KC000001 |
| | | | 12 | 5 | 250 | | 64 | 59 | 340 | 7KC000038 |
| | | | | 10 | 250 | 400 | 82 | 77 | 375 | 7KC000041 |
| | | | 18 | 5 | 250 | | 83 | 77 | 430 | 7KC000039 |
| | | | | 10 | 250 | 400 | 110 | 104 | 530 | 7KC000042 |
| | | | 24 | 5 | 250 | | 101 | 96 | 580 | 7KC000040 |
| | | | | 10 | 250 | 400 | 137 | 132 | 660 | 7KC000043 |
| 9.5/ 63.2/ 52.5 | 25.4 | 88 | 6 | 5 | 250 | | 54 | 45 | 380 | 7KC000005 |
| | | | | 10 | 250 | 400 | 58 | 50 | 400 | 7KC000044 |
| | | | | 15 | 250 | 400 | 63 | 54 | 480 | 7KC000009 |
| | | | 12 | 5 | 250 | | 73 | 65 | 530 | 7KC000006 |
| | | | | 10 | 250 | 400 | 82 | 73 | 580 | 7KC000002 |
| | | | | 15 | 250 | 400 | 91 | 83 | 740 | 7KC000010 |
| | | | 18 | 5 | 250 | | 92 | 84 | 730 | 7KC000007 |
| | | | | 10 | 250 | 400 | 105 | 96 | 800 | 7KC000035 |
| | | | | 15 | 250 | 400 | 119 | 111 | 1160 | 7KC000011 |
| | | | 24 | 5 | 250 | | 112 | 103 | 890 | 7KC000008 |
| | | | | 10 | 250 | 400 | 128 | 120 | 980 | 7KC000036 |
| | | | | 15 | 250 | 400 | 148 | 139 | 1,450 | 7KC000012 |
| 9.5/ 67.2/ 56.5 | 38.1 | 101 | 6 | 5 | 250 | | 54 | 46 | 480 | 7KC000013 |
| | | | | 10 | 250 | 400 | 58 | 50 | 530 | 7KC000003 |
| | | | | 15 | 250 | 400 | 63 | 55 | 650 | 7KC000017 |
| | | | 12 | 5 | 250 | | 74 | 65 | 730 | 7KC000014 |
| | | | | 10 | 250 | 400 | 82 | 74 | 750 | 7KC000032 |
| | | | | 15 | 250 | 400 | 92 | 83 | 930 | 7KC000018 |
| | | | 18 | 5 | 250 | | 94 | 85 | 850 | 7KC000015 |
| | | | | 10 | 250 | 400 | 106 | 98 | 970 | 7KC000033 |
| | | | | 15 | 250 | 400 | 121 | 112 | 1330 | 7KC000019 |
| | | | 24 | 5 | 250 | | 114 | 105 | 1,100 | 7KC000016 |
| | | | | 10 | 250 | 400 | 130 | 122 | 1200 | 7KC000034 |
| | | | | 15 | 250 | 400 | 150 | 141 | 1650 | 7KC000020 |
| 9.5/ 78.2/ 67.5 | 50 | 121 | 6 | 5 | 250 | | 61 | 52 | 770 | 7KC000021 |
| | | | | 10 | 250 | 400 | 65 | 56 | 820 | 7KC000030 |
| | | | | 15 | 250 | 400 | 70 | 61 | 940 | 7KC000025 |
| | | | 12 | 5 | 250 | | 80 | 72 | 980 | 7KC000022 |
| | | | | 10 | 250 | 400 | 89 | 80 | 1060 | 7KC000004 |
| | | | | 15 | 250 | 400 | 98 | 90 | 1320 | 7KC000026 |
| | | | 18 | 5 | 250 | | 100 | 92 | 1200 | 7KC000023 |
| | | | | 10 | 250 | 400 | 113 | 104 | 1350 | 7KC000031 |
| | | | | 15 | 250 | 400 | 127 | 119 | 1740 | 7KC000027 |
| | | | 24 | 5 | 250 | | 120 | 111 | 1,470 | 7KC000024 |
| | | | | 10 | 250 | 400 | 137 | 128 | 1680 | 7KC000029 |
| | | | | 15 | 250 | 400 | 156 | 147 | 2110 | 7KC000028 |

Overview

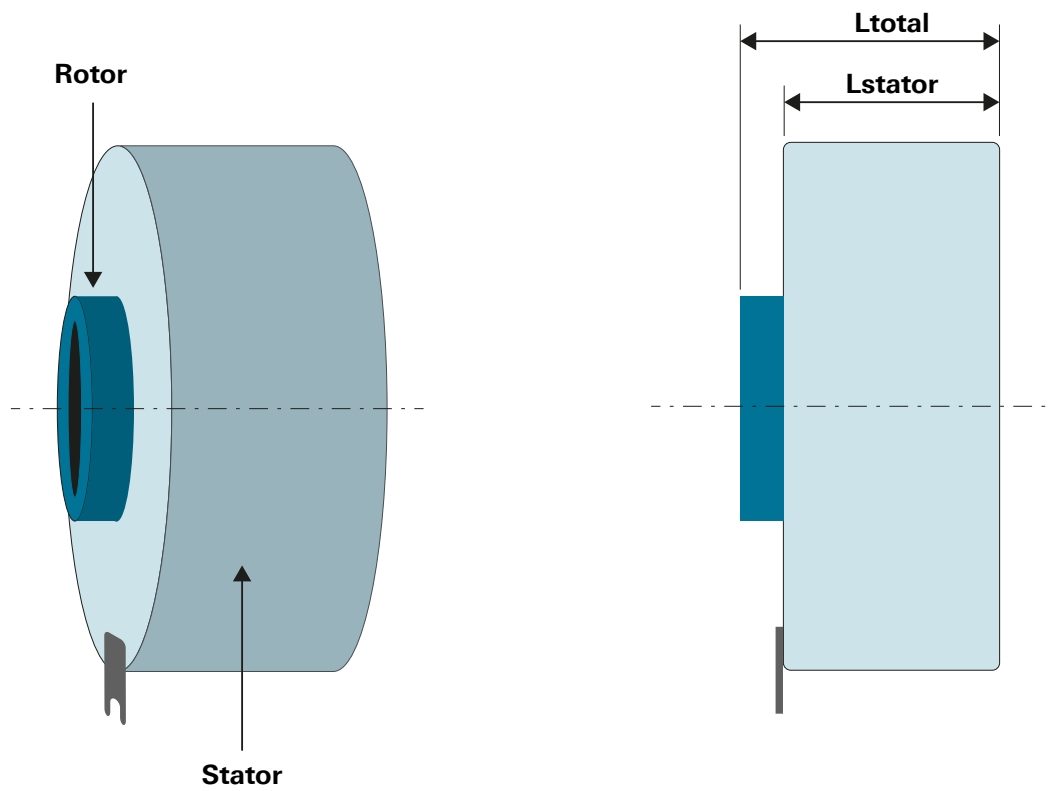

Diameter and bracket

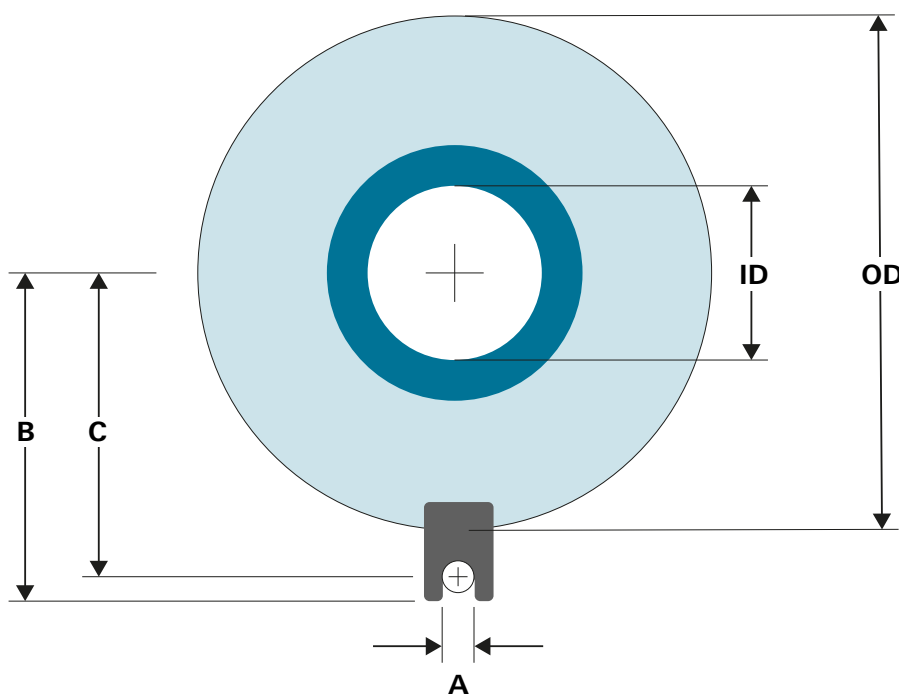

Do you have any questions about MAVERICK or do you require further information?
Contact our team of experts: **support@schleifringonline.com**

Visit us directly in the shop:

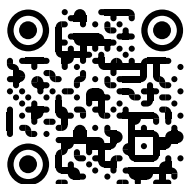

www.shop.schleifring.de

Schleifring GmbH
Maisacher Straße 144
82256 Fürstenfeldbruck
Germany
Phone + 49 8141 403 0
info@schleifring.de

Schleifring North America, LLC.
222 Mill Road
01824 Chelmsford
USA
Phone +1 978 677 2500
sales@schleifringna.com

Schleifring Transmission
Technology (Tianjin) Co., Ltd.
Wuqing district
Tianjin City 301799
P.R. China
Phone: +86 22 22978700
sales@schleifringchina.cn